



# VENT-FREE FIREPLACES

Boulevard VFLB48FP

Spec Sheet



## ACTUAL DIMENSIONS

54 3/16" W x 41 1/2" H x 11" D

## INCLUDES

- Thermostat Remote (IP Models)
- FRBC Remote (Millivolt Models)
- Fine Mesh Barrier Screen

## TECHNICAL INFORMATION

- Maximum heat output: 32,000 BTUs (LP, Nat)
- Weight: 124 lbs.
- Type of Gas: LP or Natural
- Ignition Systems: Intermittent Pilot or Millivolt
- Iron Pipe Size: 1/2-inch

## FIELD INSTALLED ACCESSORIES

- Liner with Burner Cover: Black Porcelain, White Porcelain
- Liner: Stainless Steel
- Ceramic Fiber Driftwood log and rock set
- Light Kit
- Decorative Media
- Decorative Fronts: 3/4-inch or 1-1/2-inch Matte Black

# VFLB48FP

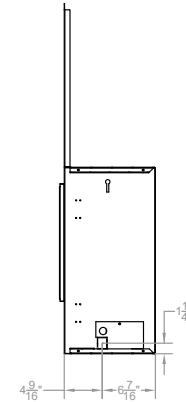
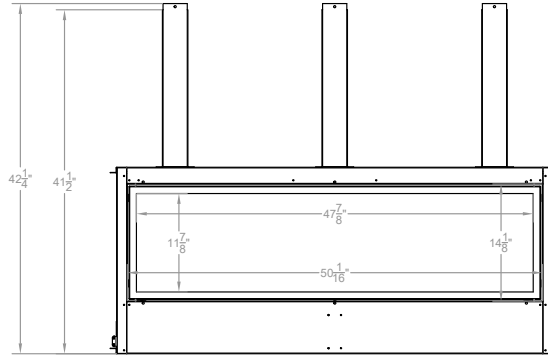
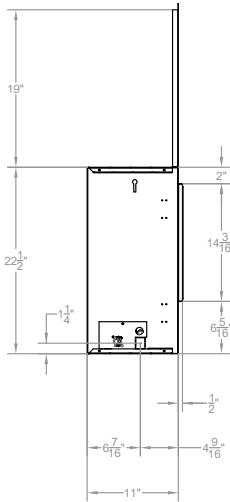
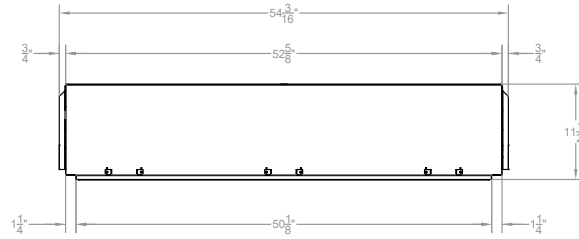

## Clearances (in inches)

	A	B	C	D	E	F
VFLB48FPOL	1/2	23	23	25	27	29
VFLB48FP	18	20	22	24	26	28

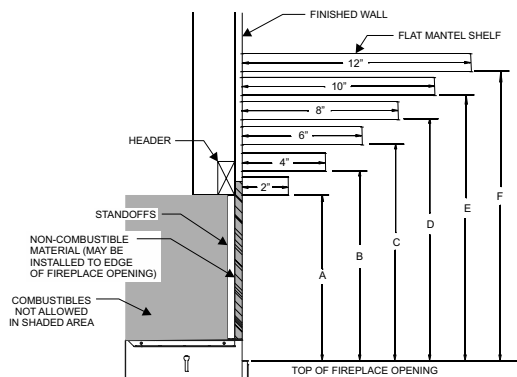

## Framing Dimensions (in inches)

VFLB48FP	
A	41 5/8
B	54 1/2
C	11 1/2

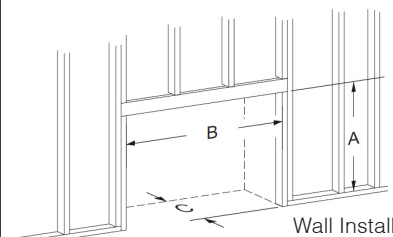
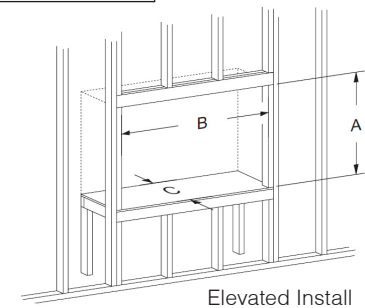

Empire is committed to continuous product improvement; specifications are subject to change without notice. Dimensions in this brochure are approximate; read and follow the framing dimensions in the owners manual supplied with your Empire product. Flame size, shape, and color will vary from photos. Our mantels feature natural veneers and hand-rubbed finishes – wood grain and color will vary. Adjust light levels and use "natural light" incandescent bulbs to enhance the dramatic look for your wooden mantel.

Member of the following industry associations:



This appliance is design-certified to the ANSI standard by:



SINCE 1932

Empire Comfort Systems Inc.

918 Freeburg Ave.

Belleville, IL 62220-2623

info@empirecomfort.com

02/19

The Empire Comfort Systems and White Mountain Hearth names and logos are registered U.S. trademarks.